

# PA-TX-09 & PA-RX-09

**18G HDMI 2.0 Cost-effective Extender Set over  
CAT5e/CAT6**



**Pro Acoustic Solutions**

**Email:** [info.proacousticsolutions@gmail.com](mailto:info.proacousticsolutions@gmail.com), [info@proacousticsolutions.com](mailto:info@proacousticsolutions.com)

**Address:** 157 Dauphin St, Mobile, AL 36602, USA

**For all International Enquiries Contact**

Holding Company: **Asahana Traders LLC**, 4th Flr. No. 402,  
Office 2, Milkyway Business Center, Shaika Maryam Bldg., Al Maktoum Rd., Dubai, UAE

## STATEMENT

Thanks for purchasing this product, please read this user manual carefully before using this product. The functions described in this version are updated till March, 2020. In the constant effort to improve our product, we reserve the right to make functions or parameters changes without notice or obligation.

## SAFETY PRECAUTION

- Do not dismantle the housing or modify the module to avoid electrical shock or burn.
- Using supplies not meeting the products' specifications may cause damage, deterioration or malfunction.
- Do not expose the unit to rain, moisture or install this product near water.
- Install the device in a place with fine ventilation.
- Do not twist or pull by force ends of the optical cable. It can cause malfunction.
- Do not use liquid or aerosol cleaners to clean this unit.
- Always unplug the power to the device before cleaning.
- Unplug the power when not used for a long period of time.
- Refer all servicing to qualified service personnel.

## AFTER-SALES SERVICE

We provide limited warranty for the product within three years.

## PRODUCT INTRODUCTION

The PA-TX-09 & PA-RX-09 is a cost-effective point-to-point extender set for HDMI 2.0 and IR signals; this kit supports 4K/UHD video @ 60 Hz with 4:4:4 Chroma sampling, as well as HDMI data rates up to 18 Gbps, HDCP 2.2 compliant; It provides HDMI transmission up to 230 feet (70 meters) for 4K@60Hz 4:4:4 or 1080p, over single CAT5e/6 cable. It supports video resolution down-scaling, the 4K input can be automatically downscale to 1080p output for compatibility with 1080p display.

## PRODUCT FEATURES

- Supports HDMI 2.0, up to 4K@60Hz 4:4:4, HDR, 18G, HDCP 2.2.
- Extends 4K or 1080p HDMI signal up to 230 feet (70m) over a single CAT5e/6 cable.
- HDMI loop out on transmitter.
- Bi-directional IR pass-through.
- Supports video resolution down-scaling, the 4K input can be automatically degraded to 1080p output on receiver for compatibility with legacy 1080p display device.
- Features visually lossless compression with no latency.
- EDID pass-through.
- Compact design, easy to install and simple to operate.

## PACKAGE CONTENTS

- |                       |                                |
|-----------------------|--------------------------------|
| • 1x Transmitter (Tx) | • 1x Power Adaptor (12V DC 1A) |
| • 1x Receiver (Rx)    | • 2x Velcro Tape               |
| • 1x IR Receiver      | • 1x User Manual               |
| • 1x IR Emitter       |                                |

**Pro Acoustic Solutions**

**Email:** [info.proacousticsolutions@gmail.com](mailto:info.proacousticsolutions@gmail.com), [info@proacousticsolutions.com](mailto:info@proacousticsolutions.com)

**Address:** 157 Dauphin St, Mobile, AL 36602, USA

**For all International Enquiries Contact**

Holding Company: **Asahana Traders LLC**, 4th Flr. No. 402,  
Office 2, Milkyway Business Center, Shaika Maryam Bldg., Al Maktoum Rd., Dubai, UAE

## TRANSMITTER PANEL DESCRIPTION

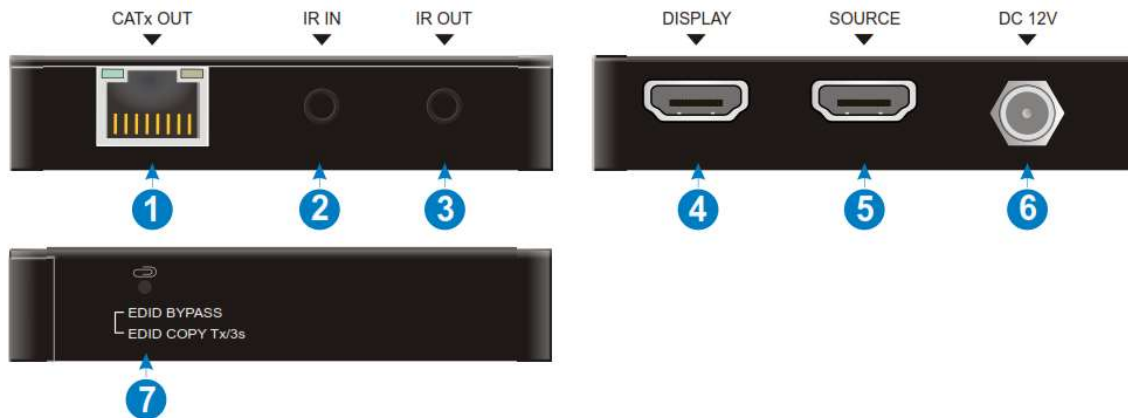

1. **CATx OUT:** RJ45 port to connect the CATx IN port of receiver by CATx cable. It supports 12V PoC to power the receiver. The orange LED illuminates when there is a valid HDMI signal input. The green LED illuminates when power is applied.
2. **IR IN:** 3.5mm mini jack to connect IR receiver for IR pass-through.
3. **IR OUT:** 3.5mm mini jack to connect IR emitter for IR pass-through.
4. **DISPLAY:** Type-A female HDMI port to connect HDMI display device.
5. **SOURCE:** Type-A female HDMI port to connect HDMI source device.
6. **DC 12V:** DC connector for the power adapter connection.
7. **EDID Management:** Press the button with paper clip or other sharp tool to set EDID bypass mode, or press and hold it for 3 seconds to copy the EDID from the display device.

**Note:** Press and hold the button while powering off, and then release it after 5 seconds of power on to restore the default setting: The source device learns EDID from the TV which has the lowest resolution.

### Pro Acoustic Solutions

Email: [info.proacousticsolutions@gmail.com](mailto:info.proacousticsolutions@gmail.com), [info@proacousticsolutions.com](mailto:info@proacousticsolutions.com)

Address: 157 Dauphin St, Mobile, AL 36602, USA

### For all International Enquiries Contact

Holding Company: **Asahana Traders LLC**, 4th Flr. No. 402,  
Office 2, Milkyway Business Center, Shaika Maryam Bldg., Al Maktoum Rd., Dubai, UAE

## RECEIVER PANEL DESCRIPTION



1. **DISPLAY:** Type-A female HDMI port to connect HDMI display device.
2. **CATx IN:** RJ45 port to connect the CATx OUT port of transmitter by CATx cable. It supports 12V PoC and the receiver can be powered from the transmitter. The orange LED illuminates when there is a valid HDMI signal input. The green LED illuminates when power is applied.
3. **IR IN:** 3.5mm mini jack to connect IR receiver for IR pass-through.
4. **IR OUT:** 3.5mm mini jack to connect IR emitter for IR pass-through.

## CONNECTION DIAGRAM

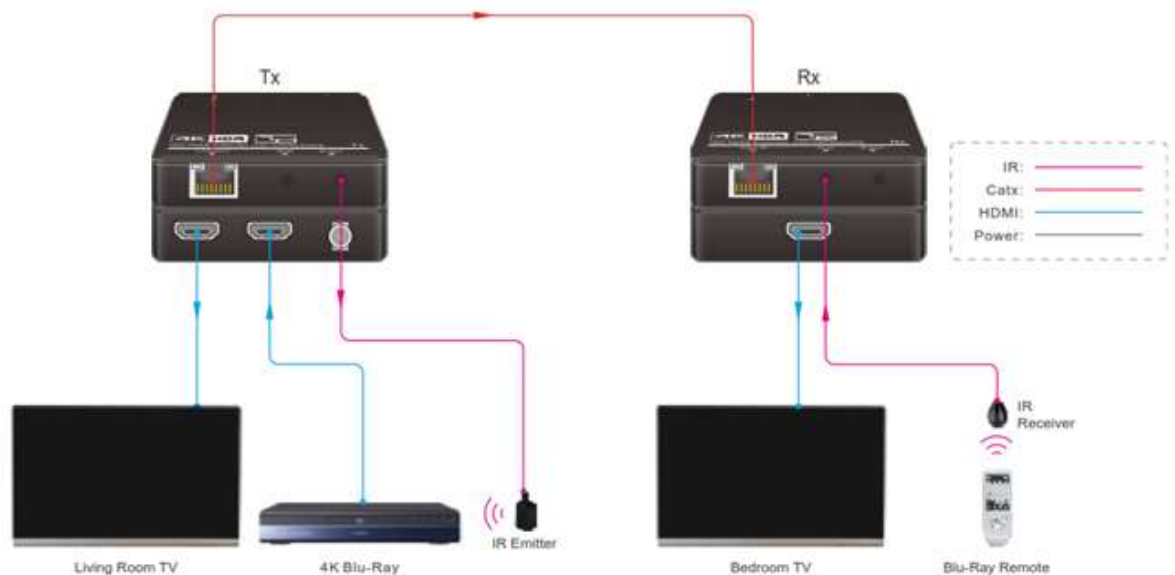

### Pro Acoustic Solutions

Email: [info.proacousticsolutions@gmail.com](mailto:info.proacousticsolutions@gmail.com), [info@proacousticsolutions.com](mailto:info@proacousticsolutions.com)

Address: 157 Dauphin St, Mobile, AL 36602, USA

### For all International Enquiries Contact

Holding Company: **Asahana Traders LLC**, 4th Flr. No. 402,  
Office 2, Milkyway Business Center, Shaika Maryam Bldg., Al Maktoum Rd., Dubai, UAE

## SPECIFICATIONS

### Transmitter

Input	(1) SOURCE
Input Connector	(1) 19-pin type-A female HDMI
Output	(1) DISPLAY, (1) CATx OUT
Output Connector	(1) 19-pin type-A female HDMI, (1) RJ45
Control	(1) IR IN, (1) IR OUT
Control Connector	(2) 3.5mm mini jacks

### Receiver

Input	(1) CATx IN
Input Connector	(1) RJ45
Output	(1) DISPLAY
Output Connector	(1) 19-pin type-A female HDMI
Control	(1) IR IN, (1) IR OUT
Control Connector	(2) 3.5mm mini jacks

### General

Video Resolution	Up to 4K@60Hz 4:4:4, HDR, 24bpp resolution,
HDMI standard	Supports HDMI 2.0,
HDCP	HDCP 2.2 signal compliance
Signal	Up to 10.2Gbps bandwidth (3.4Gbps per graphic channel),
Transmission Distance	4K/1080p = 70 meters (230ft)
HDMI Version	Up to HDMI 2.0
HDCP Version	Up to HDCP 2.2. The HDCP of output follows the HDCP version of display device.
EDID Pass-through	Supported.
Power Supply	Input: 100VAC~240VAC, 50/60Hz; Output: 12VDC 1A
Power Consumption	4W (Max)
Operation Temperature	-5~55°C
Storage Temperature	-25~70°C
Relative Humidity	10%-90%
Dimensions (W*H*D)	80mm x 16.8mm x 80mm
Net Weight	Tx/Rx: 70g

*\* All specifications are subject to change due to continuous improvements*

#### Pro Acoustic Solutions

Email: [info.proacousticsolutions@gmail.com](mailto:info.proacousticsolutions@gmail.com), [info@proacousticsolutions.com](mailto:info@proacousticsolutions.com)

Address: 157 Dauphin St, Mobile, AL 36602, USA

#### For all International Enquiries Contact

Holding Company: **Asahana Traders LLC**, 4th Flr. No. 402,  
Office 2, Milkyway Business Center, Shaika Maryam Bldg., Al Maktoum Rd., Dubai, UAE